

1. Maximum Field 35T, 32mm Bore

CELL 12 USER INTERFACE

REVISION HISTORY				
ZONE	REV	DESCRIPTION	DATE	APPROVED
	1	AL TOP PLATE DISTANCE WAS 219. NOW 196	4/19/2013	S.MAIER

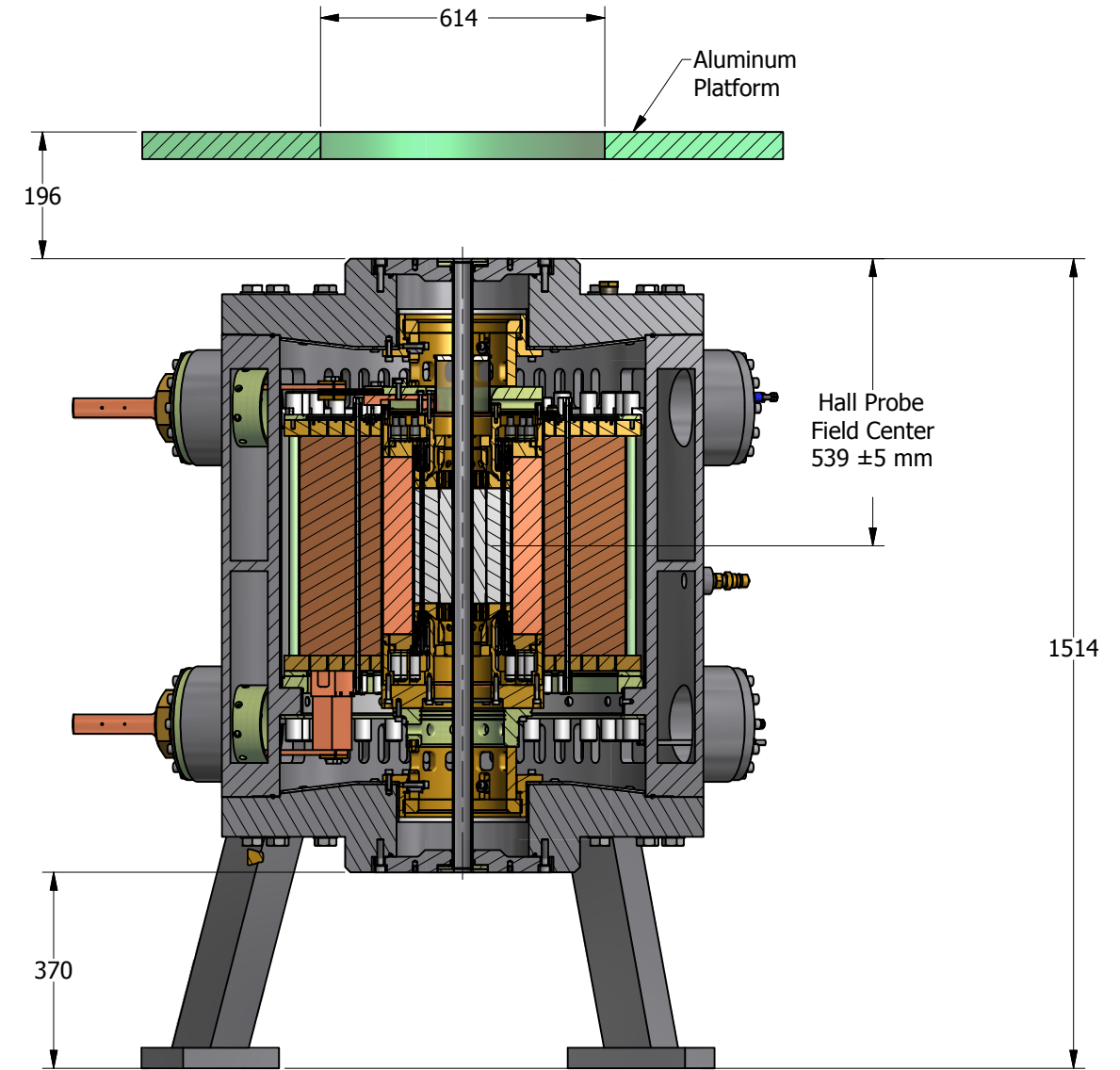
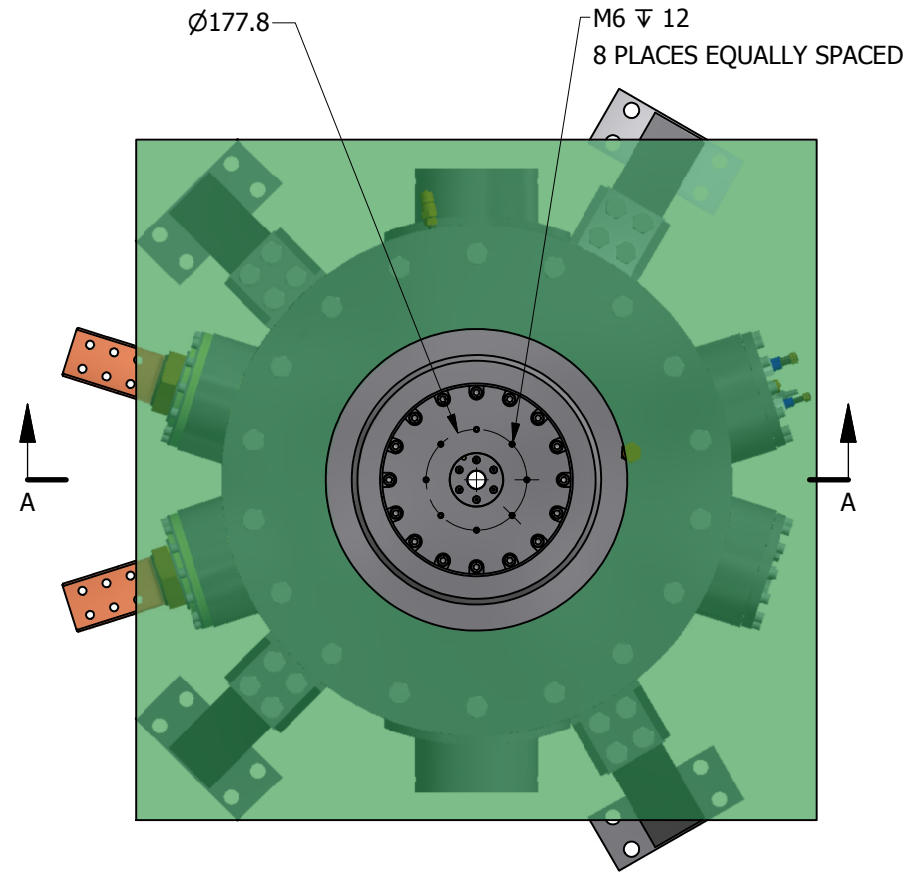

This drawing and the information it contains are both property of the Florida State University and are to be held by the recipient as confidential and are not to be transferred to any third party, used to make or furnish information for making any physical structure or any pictorial, graphic or verbal representation of any information contained herein or copied (unless supplied in productive form) without the express written consent of the Florida State University.

THIRD ANGLE PROJECTION

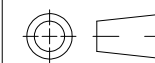

GENERAL TOLERANCES

0 PL DEC: \pm 1.00
1 PL DEC: \pm 0.25
2 PL DEC: \pm 0.10
ANGLES: \pm 1'

UNLESS OTHERWISE SPECIFIED, DIMENSIONS ARE IN MILLIMETERS. DO NOT SCALE DRAWING.

PART MODEL FILENAME
icd12.iam

MODELED
Cantrell 5/26/2011
DETAILED
Cantrell 5/26/2011
CHECKED

NATIONAL HIGH MAGNETIC FIELD LABORATORY
1800 E PAUL DIRAC DRIVE
TALLAHASSEE, FLORIDA 32310

DESC
Cell 12 Interface Assy

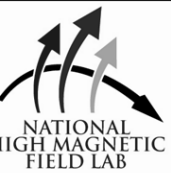

SIZE D	DWG NUMBER icd12	REV
------------------	----------------------------	-----

SHT 1 OF 1